

Applicant Contact Name: _____

Applicant Contact Phone #: _____

**MISSISSIPPI DEPARTMENT OF TRANSPORTATION
APPLICATION FOR PERMIT TO CONSTRUCT PIPELINE ALONG
OR ACROSS STATE HIGHWAY AND AGREEMENT OF APPLICANT
GIVEN IN CONSIDERATION OF SAID PERMIT**

(Please Print) Name: _____ Address: _____
Company (or) Individual Street/Route

City County State Zip Code

herein called the applicant, who at the present time proposes to construct a pipeline along or across Highway No. _____
between _____ and _____

Latitude (decimal degrees) _____ Longitude (decimal degrees) _____

in _____ County, Mississippi, does hereby make application to the Mississippi Department of Transportation, the duly authorized agent for the Mississippi Transportation Commission, for permission to construct the said pipeline mentioned above and shown herein below and in consideration of this permit being granted to said applicant for the construction of the pipeline, said applicant does hereby agree to construct the pipeline in accordance with the plan shown herein below and does further agree, with full understanding of the terms thereof, to all of the following provisions:

- (a) That the Mississippi Department of Transportation does not purport to grant to said applicant any right, title, claim or easement in or upon said highway or right-of-way appurtenant thereto.
- (b) That the said Mississippi Department of Transportation may at any time require and compel the removal, reconstruction or relocation of said pipeline or any appurtenance thereto herein described, shown or referred to, when said Mississippi Department of Transportation deems it necessary. Unless the applicant, its heirs, assigns or legal representatives, qualify under Section 65-1-8(2)(e) Mississippi Code (1972) Annotated and/or the parties have agreed otherwise in a Utility Agreement, all expense of said removal, reconstruction or relocation is to be borne exclusively by the applicant, and the Mississippi Department of Transportation is to be in no way liable.
- (c) Said applicant hereby expressly agrees for himself, his heirs, assigns and legal representatives, that upon request of said Mississippi Department of Transportation, he will without delay either reconstruct, remove or move the facility herein described to another location, all in accordance with the terms of the request so made by the said Mississippi Department of Transportation. It is distinctly understood that said new location will be made or designated by said Mississippi Department of Transportation after agreement with said applicant or its successors, if possible. It is further understood and agreed that, if this permit is granted and acted upon by the said applicant, the said Mississippi Department of Transportation will use all reasonable effort to avoid the necessity of requesting that the herein mentioned facility be removed, moved, altered, or reconstructed.
- (d) The plan of proposed construction set out below is incorporated herein by reference and made a part of this application, as if fully copied out herein in words and figures.
- (e) It is agreed that this permit is void if all work shown on this plan is not completed in accordance with this plan within one year after date of approval.
- (f) It is expressly agreed that no trees or shrubs on the highway right-of-way will be cut, trimmed, or damaged during the construction or maintenance of this work or facility except as expressly shown herein below.
- (g) All sod disturbed by the proposed work shall be neatly dressed and grassed in accordance with the vegetation schedule outlined elsewhere in this permit. The applicant shall maintain the dressed and grassed area for a sufficient length of time to insure a growing sod.
- (h) The applicant is responsible for any conflicts with other utilities on the highway right-of-way and is to secure permission from said utilities for said conflicts and for any necessary alterations.
- (i) The applicant accepts the responsibility of the safety of the traveling public and his/her workers and agrees to furnish, place and maintain traffic control devices, if required, in accordance with Part 6 of the Manual On Uniform Traffic Control Devices For Streets and Highways (MUTCD), Current Edition as a minimum. The applicant shall attach a special traffic control plan to the application if special traffic control details are required.
- (j) All work associated with this permit shall be designed, detailed and constructed in accordance with the Department's Roadway and Bridge Design Manuals and Standard Drawings and the Mississippi Standard Specifications for Road and Bridge Construction.
- (k) A copy of the approved plan is to be kept at the site of the work at all times during construction.
- (l) The applicant does hereby covenant and agree to indemnify and hold harmless the Mississippi Transportation Commission and the Mississippi Department of Transportation from and against any claims, actions, suits, causes or demands, including court costs and reasonable attorney's fees, proximately resulting from acts or omissions of the applicant, or applicant's servants, agents or employees in the construction and maintenance of all facilities outlined under this permit.

Witness my signature this _____ day of _____ 20_____, which is applicable to sheets 1
through _____ of permit number _____.

Signature of Applicant

By: _____
Printed Name and Title

STATE OF MISSISSIPPI
COUNTY OF _____

Personally appeared before me, the undersigned authority, _____ whose
Printed Name of Applicant

names(s) _____ subscribed to this instrument as the _____ of
is/are Title of Applicant

_____ who having been first fully sworn acknowledged that they
Name of Company (or) Individual

executed the above agreement as the act and deed of the said applicant for the purpose and consideration and in the capacity
therein expressed and on the date above written.

Given under my hand and seal of office this the _____ day of _____ 20____

My Commission Expires:

Signature of Notary Officer

Field Inspection By: _____ 20____

Approved: MISSISSIPPI DEPARTMENT OF TRANSPORTATION

Deputy Executive Director/Chief Engineer

By: _____ 20____

Installation Inspection By: _____ 20____

Mississippi Department of Transportation
Completion of Work Certification

This permit requires that the named applicant submit the following certification with signature(s) and insure proper filing with MDOT's District Permit Department before the permit is closed and all associated bonds are released:

Permit Representative's signature(s) acknowledges the following:

We/(I), certify that the requirements of this permit Including Attachment A (MND-002 Rev. 2-2004) have been constructed as stated in the approved final permit. Furthermore, no work performed as an exercise of the approved permit, has been relocated or altered without such change being shown on an approved revision of the permit or approved addenda thereto.

Printed Name of Applicant

Signature of Applicant

Sheet No.: 5 of _____

Permit No.: _____

Proj No.: _____

REVISIONS			
APPLICANT		MDOT	
DATE	BY	DATE	BY

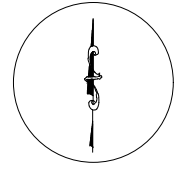

EXISTING CONDITIONS



GRAPHIC SCALE

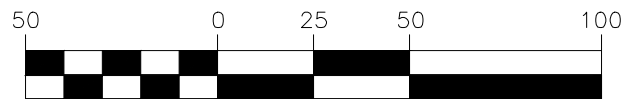

(IN FEET)
1 inch = 50 ft.

Sheet No.: 6 of _____

Permit No.: _____

Proj No.: _____

REVISIONS			
APPLICANT		MDOT	
DATE	BY	DATE	BY

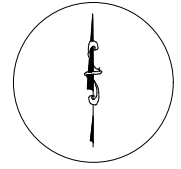

PROJECT SITE PLAN

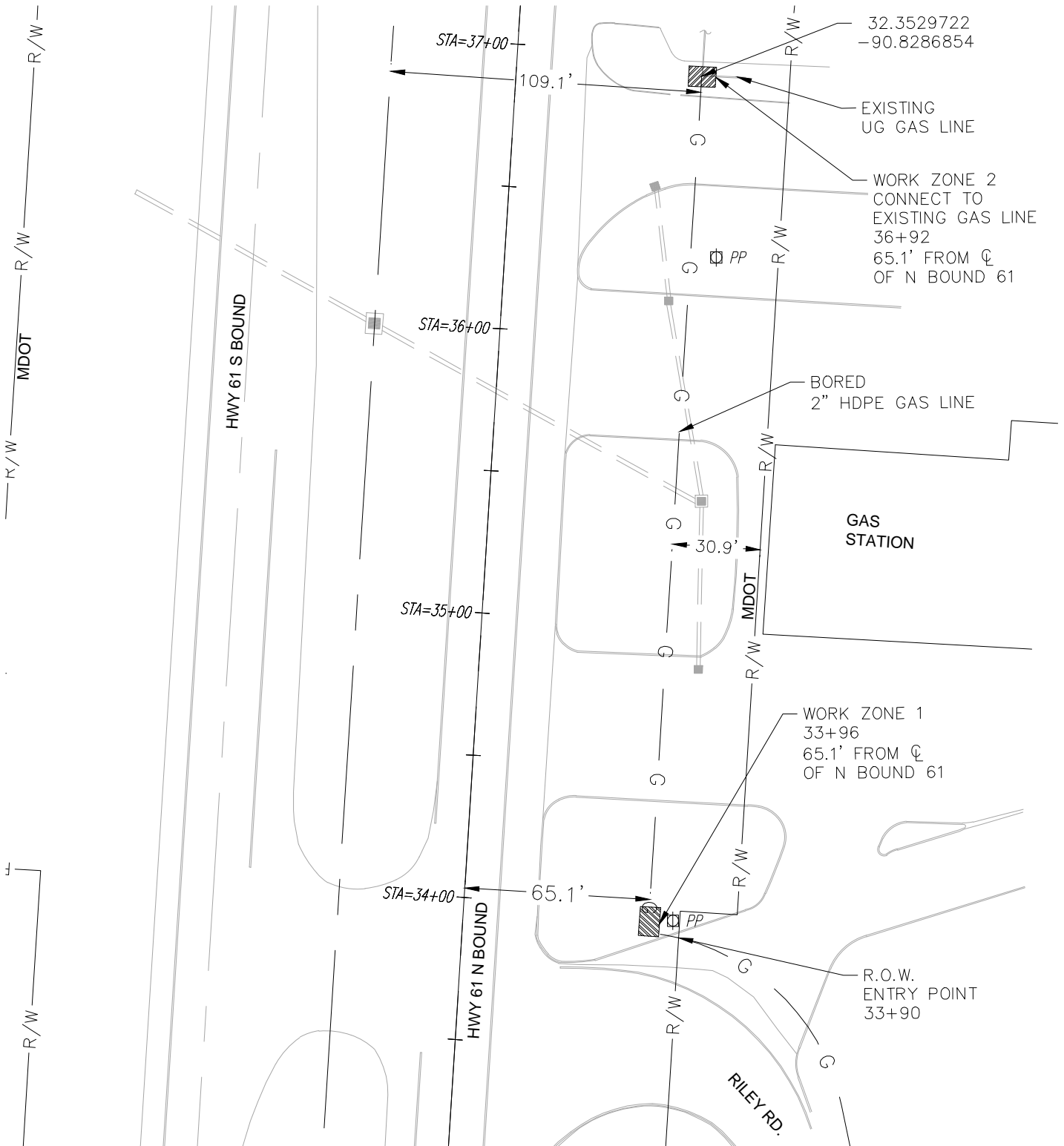

GRAPHIC SCALE

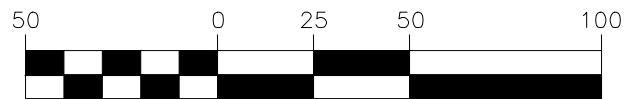

(IN FEET)
1 inch = 50 ft.